

TO: SWALE JOINT TRANSPORTATION BOARD
DATE: 14th December 2009
SUBJECT: Homewood Avenue, Sittingbourne
BY: Transportation and Development Manager – Swale
Classification: Unrestricted

Summary: A report on the public consultation carried out to implement highway improvements along Homewood Avenue

Decision Required: Approval of recommendation to implement the scheme

Introduction

1. A scheme has been developed as part of the Integrated Transport Programme to provide a safer route to the local schools along Homewood Avenue. This is proposed to be implemented by installing a shared foot/cycle path along the whole length of Homewood Avenue. The scheme which originally included traffic calming was put out to public consultation on the 1st June 2009.
2. As a consequence of public objection this scheme was withdrawn and a revised scheme (annexe A) with the traffic calming omitted was consulted on. The scheme has received approval under a Stage 1 Road Safety Audit and no issues or comments were raised. This scheme is included in the Swale Transport Strategy LTP scheme programme 2006 – 11.

Discussion

3. As a consequence of the consultation sent out to approximately 100 properties, objections from 3 residents were received. The objections were:
 - *The cycle lane on north side would be hazardous because of driveways.*
 - *The closure of one arm at the junction of Manor Grove is not appropriate because parking would obstruct access to property.*
 - *The closure of one arm at the junction of Chaucer Road would cause congestion.*
 - *The cycle path should be located on the north side.*
 - *Noise caused by high friction surface will be problematic.*
4. The proposed shared foot/cycle path is designed to encourage journeys to school by means other than a private car. There is currently a limited public transport service along this road, and the majority of children live within walking distance of the schools. The Barrow Grove school travel plan records that 31% of children want to walk or use the Walking Bus to get to and from school and 24% would like to cycle if safe to do so. Kent Highway Services have School Travel Planners working closely with the school to try to help achieve their aims.
5. Currently the cycle network in Sittingbourne is fairly disjointed and needs expansion and missing strategic links joining up. This scheme will be a positive start in addressing this issue.
6. Funding towards this scheme has been assigned by Sustrans (a Sustainable Transport Charity) who are keen to provide financial assistance towards schemes

that improve routes to school. Sustrans is very keen to see this scheme developed.

7. The junctions of Chaucer Road and Manor Grove have double arm junctions with Homewood Avenue. It is proposed to close one arm of each junction to reduce conflict between vehicles and pedestrians/cyclists.
8. Formal crossing facilities have been considered and a survey was carried out during term time to determine the level of pedestrians crossing Homewood Avenue. The surveys were carried out between Borden Lane to Berkeley Court and Berkeley Court to College Road. The results of the survey showed that there is very low pedestrian demand outside of school start and finish times, making the introduction of a formal crossing inappropriate. The school operates a school crossing patrol and after discussion with the head teacher it was considered to enhance this facility by providing informal crossing points (highlighted with coloured surfacing) just to the east of the junction with Berkeley Court.
9. Accessibility at the bus stops will also be improved as part of this scheme.

Decision Required

10. Members are asked to recommend approval of the scheme as shown.
11. This scheme has been deferred for budgetary reasons and will be put forward for inclusion in the 2010/11 Integrated Transport Schemes construction programme.

Contact Officer:
Stephen Huckle 01233 614097
Stephen.huckle@kent.gov.uk



Homewood Avenue, Sittingbourne – Proposed Traffic Management Scheme and Cycle Route

Consultation Sheet

Location

Homewood Avenue is a residential road located to the south of Sittingbourne Town Centre and forms an important link across town.

A scheme was proposed to install traffic calming and a shared use foot/cycle path along the southern side of Homewood Avenue.

However after public consultation objections were received and the scheme has now been amended and the proposed traffic calming has been removed from the scheme and the route of the shared path altered.

What are we planning to do?

A plan showing the proposed measures is shown on the back of this leaflet. This involves closing off one of the junction arms of Manor Grove and Chaucer Road (similar to that done at College Road). The shared foot/cycle path is still proposed along the southern side of Homewood Avenue from Ufton Lane but with a crossing point to the west of College Road and then continuing on the northern side up to Borden Lane. A crossing facility (dropped kerbs) is provided to the east of Berkeley Court to assist pedestrians crossing to the school.

How will we carry out the work?

There are no plans at present to construct the proposed traffic management scheme, until residents have had an opportunity to write in with their views on the scheme. Therefore if you have any views or comments to make regarding the proposals please write to;

Swale Transportation Manager
Kent Highway Services
Ashford Highway Depot
4 Javelin Way
Ashford
Kent, TN24 8AD

If no significant objections to the proposals are received from residents, design of the traffic management scheme will continue with work to construct the scheme being carried out next year (2010).

All views and comments **MUST** be received by Friday 20th November 2009 in order for them to be presented to Members of the next Joint Transportation Board which is to be held in December 2009.

How to Contact us?

For further information in the first instance please call Kent Highway Services on our 24hr helpline 0845 824 7800 or email www.kent.gov.uk/highways

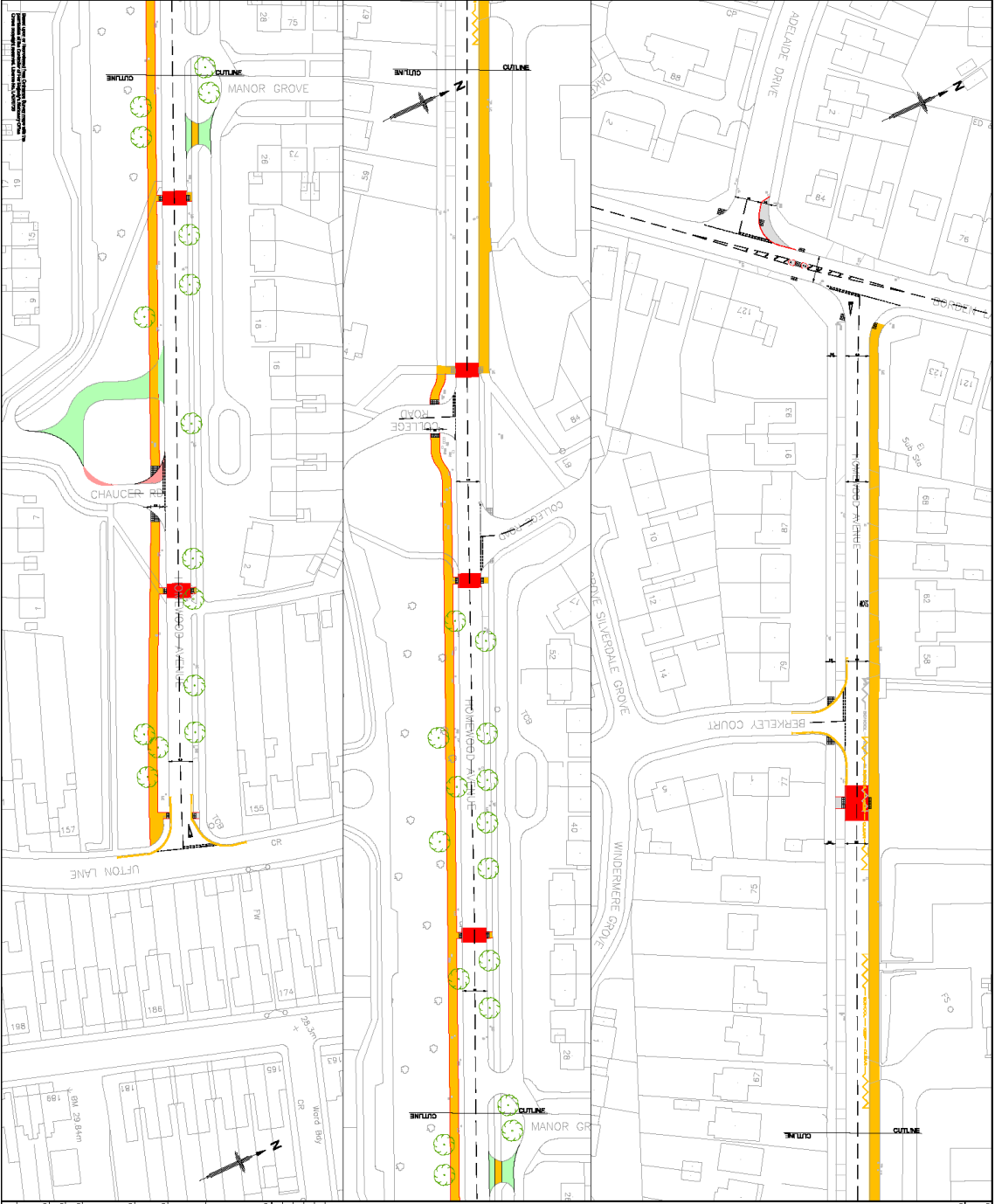

DRAFT

B1200500/01			
<p>Proposed High Capacity Bus Stop 1.2m x 2.4m x 2.4m (4' x 8' x 8') on Opposite Side of Road Proposed 2.0m Wide Footway/Cycleway</p>			
<p>Proposed Busway</p>			
<p>Proposed High Capacity Bus Stop</p>			
<p>Proposed Cycleway</p>			
<p>Proposed Way</p>			
<p>Proposed 1.2m Wide Speedster Refuge Island</p>			
<p>Proposed Double Yellow Lines</p>			
JACOBS CONSULTANTS 1st Floor, 45 St James Street, Birmingham, B2 4JD Homewood Avenue, Stiffington Proposed School Route to School			
For Consultation 1500 @ A1 Do not scale B1200500/01 C			